

LO D10-1

Choke can be made on the annealed laminations thick of 0.3 mm for an additional charge 12USD. The OT10 cover fits perfectly to D10-1.

Caption

L	inductance, $f = 120\text{Hz}$	price	price
sizes	overall dimensions	core	core type
weight	approximate weight	R	resistance
I _{max}	maximum current		

Specyfikacje

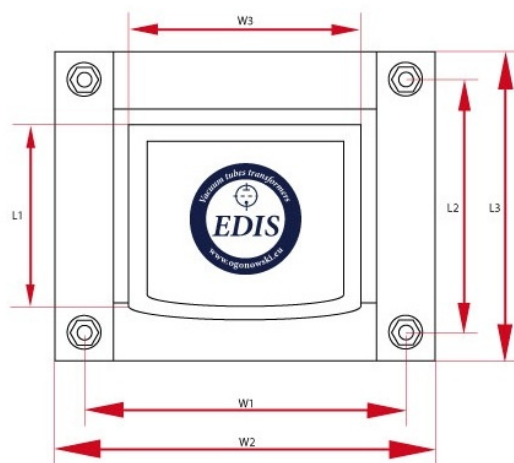
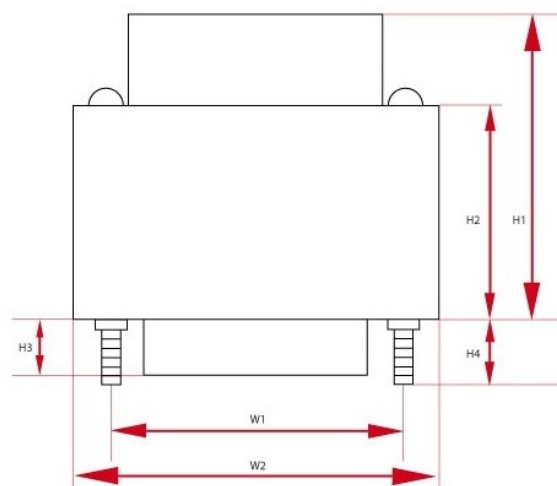

Choke - LO D10-1 - wersja z jednym dekielkiem (PL)

L	R	I _{max}	Core	Size W	Size H	Size L	Weight	Count
10 H	72 Ω	300 mA	EI84/42	W1 - 110 mm W2 - 110 mm W3 - 110 mm	H1 - 110 mm H2 - 110 mm	L1 - 110 mm L2 - 110 mm L3 - 110 mm L4 - 110 mm	1.9 kG	1

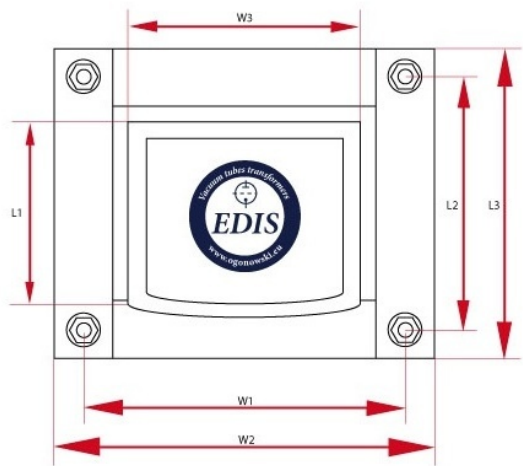
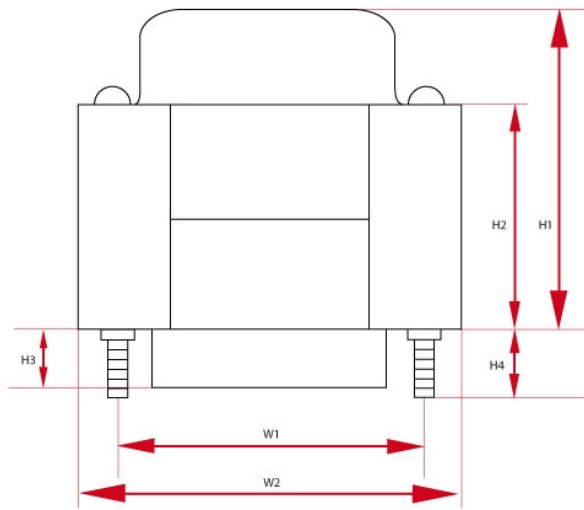

Choke - LO D10-1 - wersja z jednym dekielkiem (DE)

L	R	I _{max}	Core	Size W	Size H	Size L	Weight	Count
10 H	72 Ω	300 mA	EI84/42	W1 - 110 mm W2 - 110 mm W3 - 110 mm	H1 - 110 mm H2 - 110 mm	L1 - 110 mm L2 - 110 mm L3 - 110 mm L4 - 110 mm	1.9 kG	1