

LO D75-1

The choke is made of annealed laminations thick of 0.3 mm.

Caption

| | | | |
|------------------|-----------------------|--------|--------------------|
| I _{max} | maximum current | sizes | overall dimensions |
| core | core type | R | resistance |
| L | inductance, f = 120Hz | weight | approximate weight |
| price | price | | |

Specyfikacje

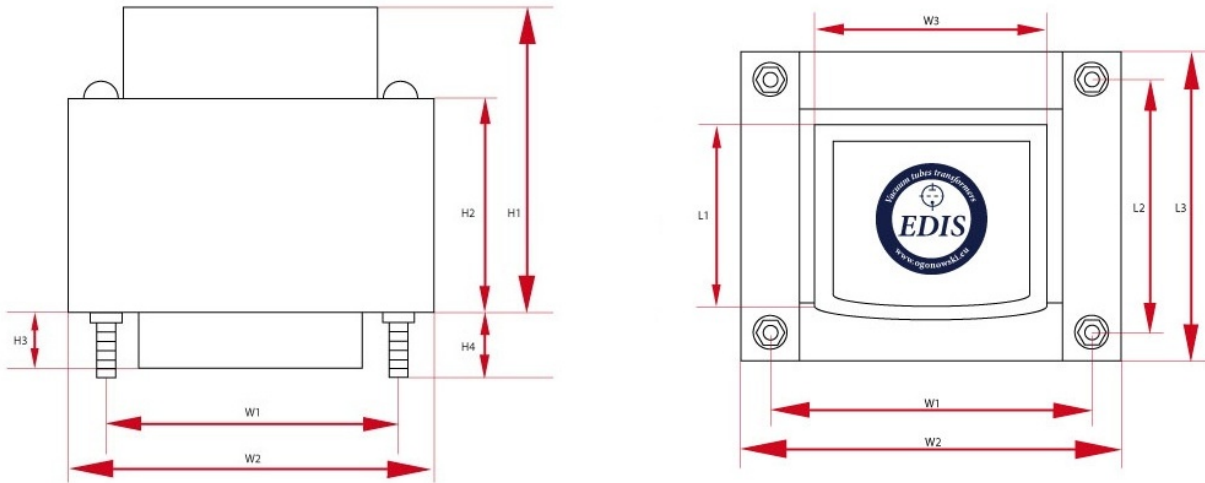

| Choke - LO D75-1 - wersja z jednym dekielkiem (PL) | | | | | | | | |
|--|--------|------------------|---------|---|----------------------------|--|---------|-------|
| L | R | I _{max} | Core | Size W | Size H | Size L | Weight | Count |
| 75 H | 1800 Ω | 20 mA | EI54/18 | W1 - 110 mm W2 - 110 mm W3 - 110 mm | H1 - 110 mm H2 - 110 mm | L1 - 110 mm L2 - 110 mm L3 - 110 mm L4 - 110 mm | 0.37 kG | 1 |

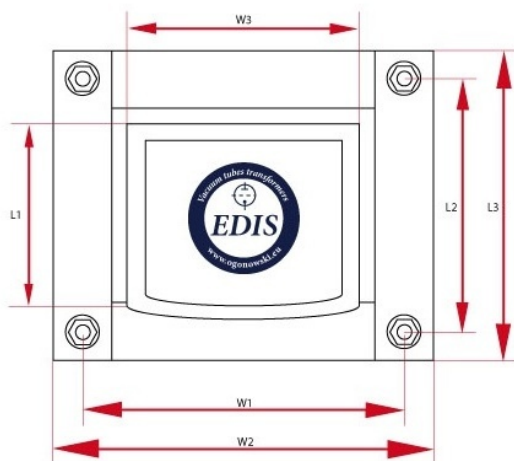
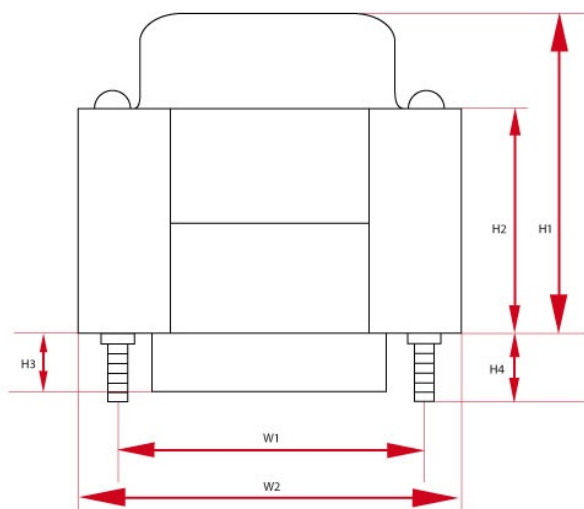

Choke - LO D75-1 - wersja z jednym dekielkiem (DE)

| L | R | I_{\max} | Core | Size W | Size H | Size L | Weight | Count |
|------|---------------|------------|---------|---|----------------------------|--|---------|-------|
| 75 H | 1800 Ω | 20 mA | EI54/18 | W1 - 110 mm W2 - 110 mm W3 - 110 mm | H1 - 110 mm H2 - 110 mm | L1 - 110 mm L2 - 110 mm L3 - 110 mm L4 - 110 mm | 0.37 kG | 1 |