

## TS80-2

Fits to the transformer, cover OT-10 (dimensions 10x10x10cm - accessories section). Core Ei84/42, usually laminations thick 0,5mm. The surcharge for the version on the annaelad laminations thick 0,3mm is 17 USD.

## Caption

$f_{zas}$	operating frequency	core	core type
weight	approximate weight	$U_{n/In}$	output voltage for current
$U_{we}$	input voltage	$P_{max}$	maximum power
sizes	overall dimensions	price	price

## Specyfikacje

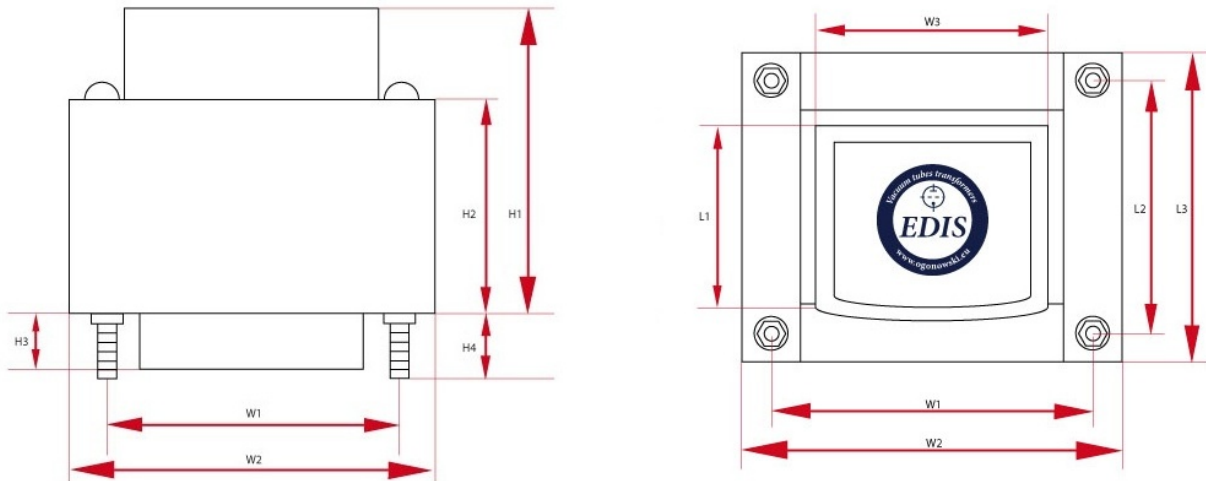

### Power Transformer - TS80-2 - wersja z jednym dekielkiem (PL)

$P_{max}$	$U_{in}$	$F_z$	Core	Size W	Size H	Size L	Weight
80 W	230 V	50 Hz	Ei84/42	W1 - 110 mm W2 - 110 mm W3 - 110 mm	H1 - 110 mm H2 - 110 mm	L1 - 110 mm L2 - 110 mm L3 - 110 mm L4 - 110 mm	2 kg
$U_{a1}$	$U_{a2}$	$U_{a3}$	$U_{a4}$	$U_{a5}$	$U_{a6}$	$U_{a7}$	$U_{a8}$
250V/200mA	6,3V/2A	-	-	-	-	-	-
Ostona	Count						
OT10	1						

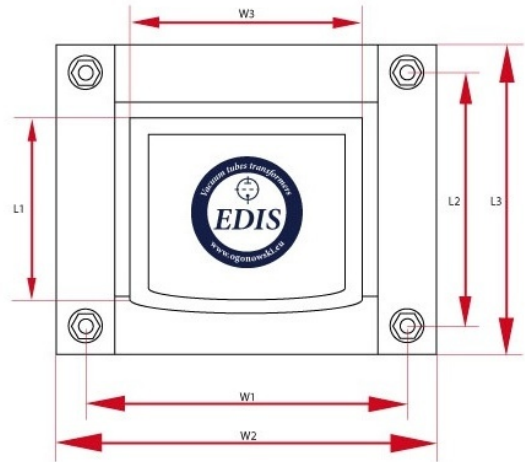
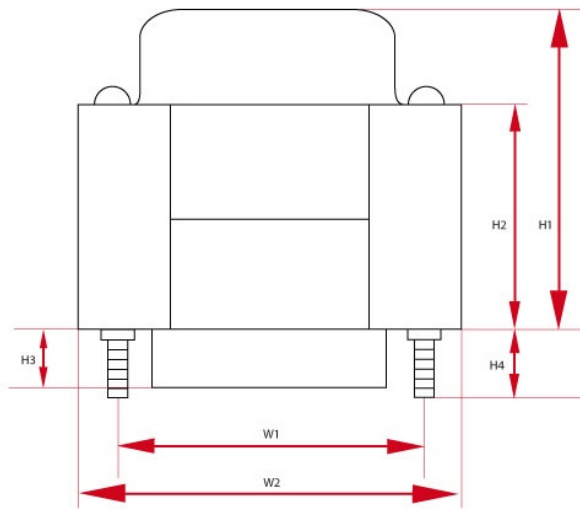

Power Transformer - TS80-2 - wersja z jednym dekielkiem (DE)

$P_{max}$	$U_{in}$	$F_z$	Core	Size W	Size H	Size L	Weight
80 W	230 V	50 Hz	EI84/42	W1 - 110 mm W2 - 110 mm W3 - 110 mm	H1 - 110 mm H2 - 110 mm	L1 - 110 mm L2 - 110 mm L3 - 110 mm L4 - 110 mm	2 kg
$U_{a1}$	$U_{a2}$	$U_{a3}$	$U_{a4}$	$U_{a5}$	$U_{a6}$	$U_{a7}$	$U_{a8}$
250V/200mA	6,3V/2A	-	-	-	-	-	-
Ostona	Count						
OT10	1						