

TS300-6

For transformer protection shield fits OT14. Transformer can be made on the annealed laminations thick 0.3 mm for an additional charge 29USD.

Caption

$f_{zas}$	operating frequency	$U_{n/In}$	output voltage for current
core	core type	$U_{we}$	input voltage
$P_{max}$	maximum power	weight	approximate weight
price	price	sizes	overall dimensions

Specyfikacje

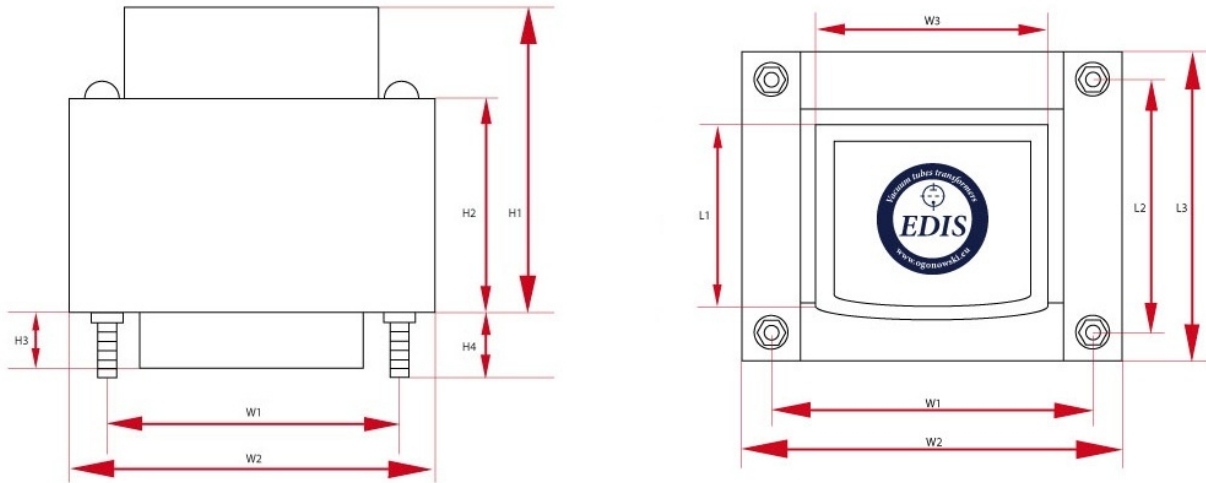

Power Transformer - TS300-6 - wersja z jednym dekielkiem (PL)							
$P_{max}$	$U_{in}$	$F_z$	Core	Size W	Size H	Size L	Weight
300 W	230 V	50 Hz	EI120/53	W1 - 110 mm W2 - 110 mm W3 - 110 mm	H1 - 110 mm H2 - 110 mm	L1 - 110 mm L2 - 110 mm L3 - 110 mm L4 - 110 mm	5 kg
$U_{a1}$	$U_{a2}$	$U_{a3}$	$U_{a4}$	$U_{a5}$	$U_{a6}$	$U_{a7}$	$U_{a8}$
0-10-160V/0,4A	290V/0,06A	90V/0,06A	6,3V/2A	12,6V/5A	-	-	-
Oslona	Count						
-	1						

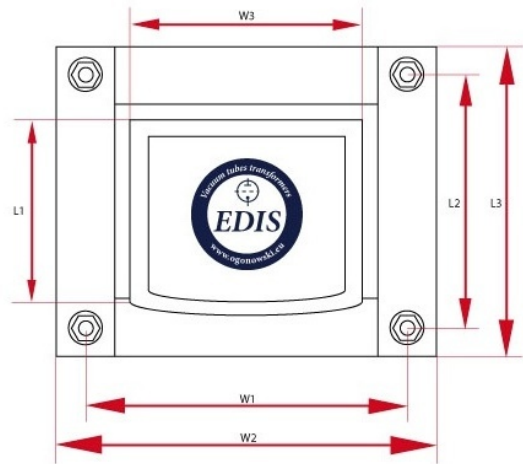
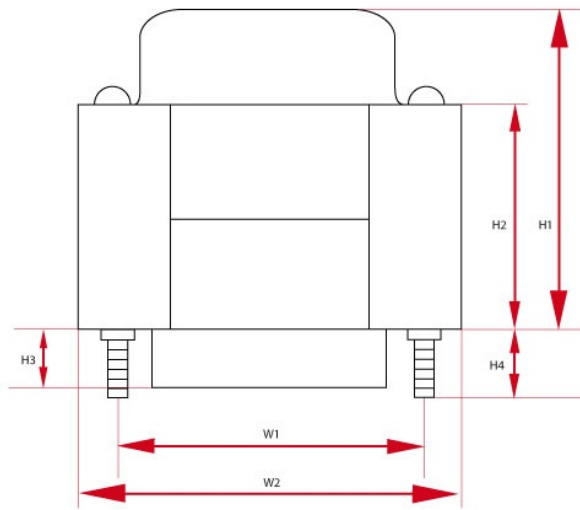

Power Transformer - TS300-6 - wersja z jednym dekielkiem (DE)

$P_{max}$	$U_{in}$	$F_z$	Core	Size W	Size H	Size L	Weight
300 W	230 V	50 Hz	EI120/53	W1 - 110 mm W2 - 110 mm W3 - 110 mm	H1 - 110 mm H2 - 110 mm	L1 - 110 mm L2 - 110 mm L3 - 110 mm L4 - 110 mm	5 kg
$U_{a1}$	$U_{a2}$	$U_{a3}$	$U_{a4}$	$U_{a5}$	$U_{a6}$	$U_{a7}$	$U_{a8}$
0-10-160V/0,4A	290V/0,06A	90V/0,06A	6,3V/2A	12,6V/5A	-	-	-
Ostona	Count						
-	1						