

LO PP60-1

The transformer is made on the annealed cores, thickness of laminations 0.3 mm .

Caption

price	price	$P_{max}$	maximum power
weight	approximate weight	$I_{max}$	maximum current
$L_{aa}$	inductance of the anode-anode, $f=120\text{Hz}$	$R_o$	load resistance
$Z_{aa}$	anode-anode impedance	$f_{max}$	maximum frequency
$k_{n:n}$	transmission	core	core type
UL	peel off the ultra-linear	$R_{aa}$	resistance of the anode-anode
$f_{min}$	minimum frequency	sizes	overall dimensions

Specyfikacje

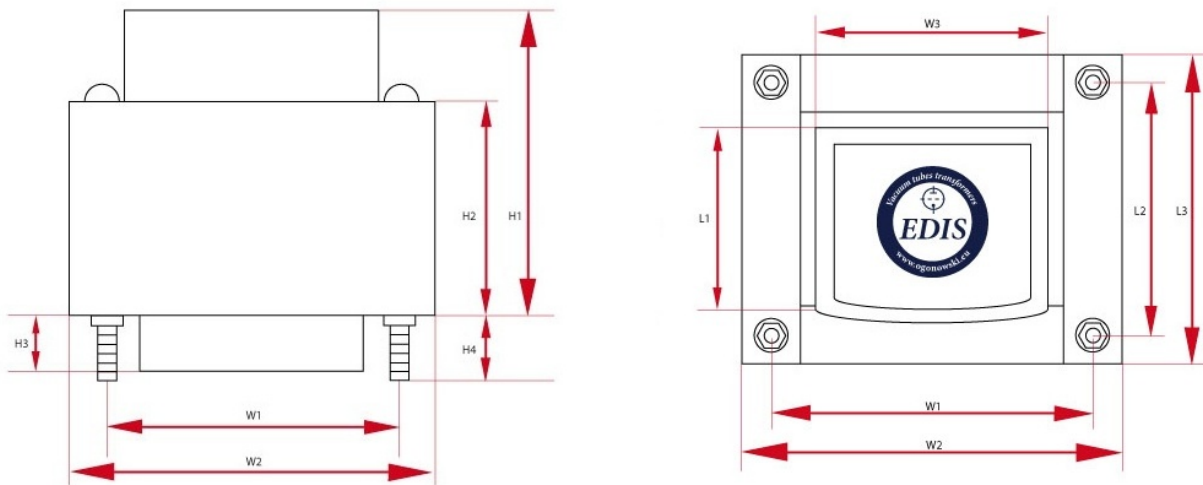

Push Pull - LO PP60-1 - wersja z jednym dekielkiem (PL)							
$P_{max}$	$Z_a$	$I_{max}$	$R_{aa}$	UL	$k_{n:n}$	$R_o$	$L_a$
60 W	6600 $\Omega$	200 mA	155 $\Omega$	43 %	40.6 : 1, 28.7 : 1	4 and 8 $\Omega$	47 H
$f_{min}$	$f_{max}$	Core	Size W	Size H	Size L	Weight	Count
10Hz @ -3dB 20Hz @ +/-1dB	60kHz @ -3dB 20kHz @ +/-1dB	EI96/59	W1 - 110 mm W2 - 110 mm W3 - 110 mm	H1 - 110 mm H2 - 110 mm	L1 - 110 mm L2 - 110 mm L3 - 110 mm L4 - 110 mm	3.5 kG	1
Price							
1-5 units		5+ units		10+ units		25+ units	
149.0 USD		142.0 USD		134.0 USD		127.0 USD	

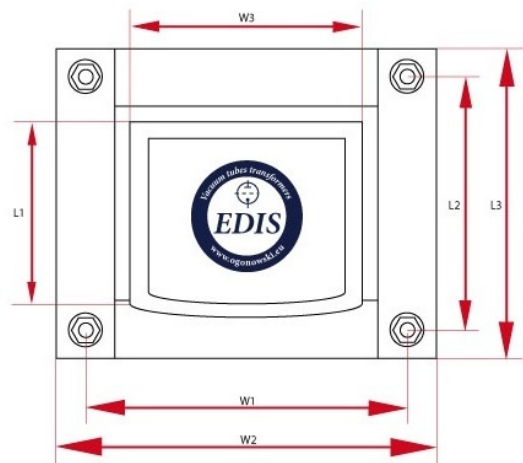
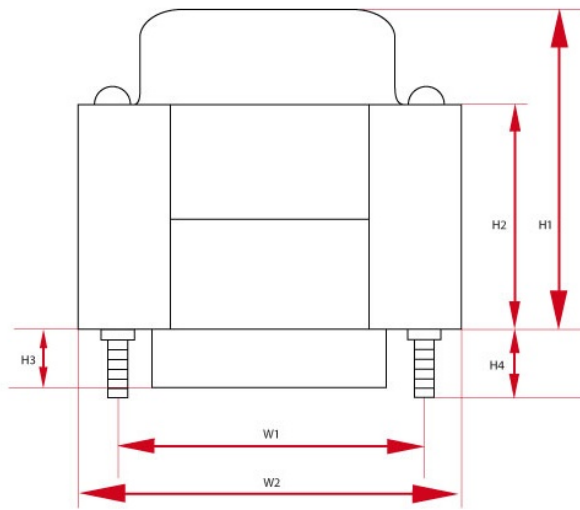

Push Pull - LO PP60-1 - wersja z jednym dekielkiem (DE)

$P_{max}$	$Z_a$	$I_{max}$	$R_{aa}$	UL	$k_{n:n}$	$R_o$	$L_a$
60 W	6600 $\Omega$	200 mA	155 $\Omega$	43 %	40.6 : 1, 28.7 : 1	4 and 8 $\Omega$	47 H
$f_{min}$	$f_{max}$	Core	Size W	Size H	Size L	Weight	Count
10Hz @ -3dB 20Hz @ +/-1dB	60kHz @ -3dB 20kHz @ +/-1dB	EI96/59	W1 - 110 mm W2 - 110 mm W3 - 110 mm	H1 - 110 mm H2 - 110 mm	L1 - 110 mm L2 - 110 mm L3 - 110 mm L4 - 110 mm	3.5 KG	1
Price							
1-5 units		5+ units		10+ units		25+ units	
149.0 USD		142.0 USD		134.0 USD		127.0 USD	